

JOB: -

JOB NO.: -

TO: -

ADDENDA DRAWING #

DOWEL INTO EXISTING CURB 3" AND PLACE 1/2" X 12" SMOOTH DOWEL ALIGNED WITH HORIZONTAL BARS. EPOXY IN (E) CURB W/ HILTI HIT HY 150. GREASE EXPOSED END BEFORE NEW PCC PLACED.

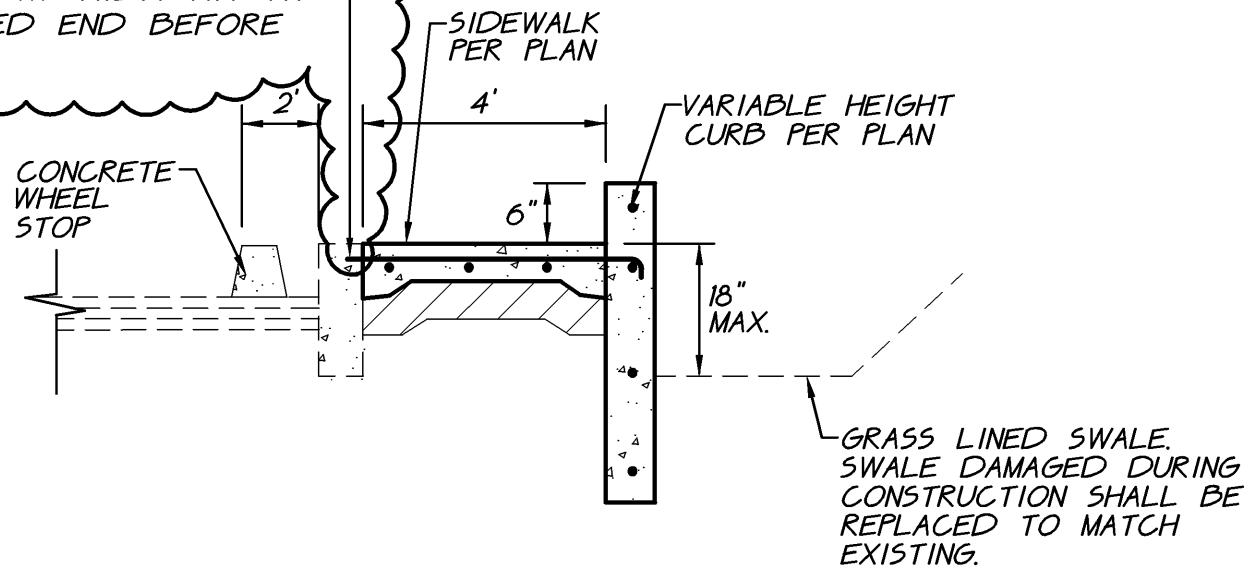

C
C3.1

SECTION

NO SCALE