



6602 Owens Drive, Suite 100
Pleasanton, California 94588
www.atcassociates.com
925.460.5300
Fax: 925.463.2559

Environmental, Geotechnical and Materials Professionals

November 9, 2009

Ms. Ann Mehta
Yuba County
915 8th Street
Marysville, California 95901

**RE: UPDATED ASBESTOS SURVEY REPORT
SOUTH ANNEX BUILDING
938 14TH STREET, MARYSVILLE, CA 95901
ATC PROJECT NO. 75.38867.0001**

Dear Ms. Metha:

At the request of Yuba County, ATC Associates Inc. (ATC) performed an asbestos survey at the South Annex Building, located at 938 14th Street in Marysville, California (herein referred to as the "site") on May 20 and 21, and ATC performed additional sampling at the site on November 5, 2009. The purpose of the survey was to identify asbestos containing materials (ACMs) at the site in a nondestructive investigation limited to accessible materials. The purpose of the additional sampling was to determine if debris located within the boiler room of the site contains asbestos. The survey and additional sampling was conducted by ATC Project Hygienist Mr. Daniel Moran, California Division of Occupational Safety and Health (DOSH) Certified Site Surveillance Technician (CSST) # 08-4417 and ATC Project Manager Mr. Paul Lowe, DOSH Certified Asbestos Consultant (CAC) # 07-4137.

I. ASBESTOS SAMPLING AND ANALYSIS

A total of one-hundred and three (103) bulk samples of suspect ACMs were collected at the site on May 20 and 21, and an additional three (3) bulk samples of suspect asbestos containing debris were collected at the site on November 5, 2009. Hygeia Laboratories, Inc. located in Sierra Madre, California (Hygeia) analyzed the samples by Polarized Light Microscopy (PLM) in accordance with the EPA "Method for the Determination of Asbestos in Bulk Building Materials" (EPA/600/R93/116, July 1993). Hygeia is certified by the State of California Department of Health Services and accredited by the American Industrial Hygiene Association. Hygeia is a participant in the Environmental Laboratory Accreditation Program, NIST/NVLAP Accreditation, for PLM analysis. The table below provides a summary of the laboratory PLM results of the materials sampled at the site on May 20 and 21, and November 5, 2009. Copies of the laboratory analytical reports and the inspector certifications and laboratory accreditations are included as Attachments A and B of this report.

SOUTH ANNEXBUILDING 938 14TH STREET, MARYSVILLE, CA 95901 ASBESTOS PLM ANALYTICAL RESULTS				
SAMPLE NUMBER	MATERIAL DESCRIPTION	SAMPLE LOCATION	QUANTITY	LABORATORY RESULTS
1A 1B 1C	Grey Roll Roofing with Black Tar	Roof Over Boiler Room Eastern Roof Northwest Roof	NA	ND
2A 2B 2C	Brown Roof Shingle with Black Tar Paper	Far East Roof Roof Over Kitchen Southwest Roof	NA	ND
3A 3B 3C	Black Penetration Mastic	West Central Roof Southwest Central Roof East Central Roof	NA	ND
4A 4B 4C	Silver Foam Roof	Roof Over Boiler Room South Central Roof Over Boiler Room East Roof Over Boiler Room Northwest	NA	ND
5A 5B 5C	Grey HVAC Duct Caulk	South Central Roof Central Roof West Roof	NA	ND
6A 6B 6C	Grey Caulk At Flashings	South Central Roof East Roof Northwest Roof	NA	ND
7A 7B 7C	Boiler Insulation	Large Boiler Double Boiler (Right) Double Boiler (Left)	1,000 SF	10% Chrysotile; 15% Amosite
8A 8B 8C	Pipe Insulation	Small Boiler (Between Large) Double Boiler (Right) Double Boiler (Left)	200 LF	20% Chrysotile
9A 9B 9C	Mudded Elbow	Double Boiler Right Pipe Double Boiler Right Elbow Double Boiler Left Elbow	60 EA	90% Chrysotile
10A 10B 10C	Brown Fiberboard Material	Boiler Room Ceiling (Ent.) Boiler Room Side Ceiling Boiler Room (Near Restroom)	NA	ND
11A 11B 11C 11D 11E 11F 11G	Wallboard with Joint Compound	Shop Room Stairway West Wing Closet Southeast Office- Middle Wing North Closet- East Wing Restroom Hallway- East Wing Restroom- Northwest Wing Hallway- Southwest Wing	NA	ND
12A 12B 12C 12D 12E 12F 12G	Wall Texture	Shop Room Stairway West Wing Closet Southeast Office- Middle Wing North Closet- East Wing Restroom Hallway- East Wing Restroom- Northwest Wing Hallway- Southwest Wing	NA	ND
13A	4" Tan Cove Base with Brown Mastic	Break Room- Middle Wing	NA	ND

SOUTH ANNEXBUILDING 938 14TH STREET, MARYSVILLE, CA 95901 ASBESTOS PLM ANALYTICAL RESULTS				
SAMPLE NUMBER	MATERIAL DESCRIPTION	SAMPLE LOCATION	QUANTITY	LABORATORY RESULTS
14A	Cream (Tan) Square Pattern Linoleum	Break Room- Middle Wing	NA	ND
15A	Tan (Yellow) Linoleum	Break Room- Middle Wing	200 SF	Flooring: 30 % Chrysotile
16A	Light Blue Speckled Linoleum	Rest Room- Middle Wing	NA	ND
17A	Gray/Blue Square Pattern Linoleum	Hallway Restroom- Middle Wing	NA	ND
18A 18B 18C	Tan Carpet Mastic Under Green Carpet	Office A- Middle Wing Office B- Middle Wing Office C- Middle Wing	NA	ND
19A 19B 19C	4" Dark Green Cove Base with White Mastic	Office A- Middle Wing Office B- Middle Wing Office C- Middle Wing	NA	ND
20A 20B 20C	White 2 x 4 Fissure Pattern Ceiling Tiles	Hallway- East Wing Break Room- East Wing Office C- East Wing	NA	ND
21A 21B 21C	12" Light Green Speckled Floor Tile with Mastic	Entry Hall- East Wing Break Room- East Wing Rest Room Hall- East Wing	NA	ND
22A 22B 22C	Grey Pebble Pattern linoleum	Women's Rest Room- East Wing Men's Rest Room- Southeast Wing Women's Rest Room- Southeast Wing	NA	ND
23A	12" White Speckled Floor Tile with Mastic	Rest Room- Northwest Wing	NA	ND
24A 24B 24C	4" Grey Cove Base with Mastic	Rest Room- Northeast Wing Hall- Northeast Wing Entry- Northeast Wing	NA	ND
25A 25B 25C	Yellow Carpet Mastic Under Pink Carpet	West Office- East Wing North Closet- East Wing North Office- East Wing	NA	ND
26A 26B	Grey/White (Tan) Pebble Pattern Vinyl Flooring	Women's Rest Room- Northeast Wing Men's Rest Room- Northeast Wing	160SF	30% Chrysotile
27A	12" Cream Vinyl Floor Tile with Streaks and Mastic	Rest Room- Northwest Wing	160SF	Tile: <1% Chrysotile; Mastic: ND

SOUTH ANNEXBUILDING 938 14 TH STREET, MARYSVILLE, CA 95901 ASBESTOS PLM ANALYTICAL RESULTS				
SAMPLE NUMBER	MATERIAL DESCRIPTION	SAMPLE LOCATION	QUANTITY	LABORATORY RESULTS
28A 28B 28C	6" Red Ceramic Tile with Grout and Brown Mastic	Old Kitchen Work Room Old Kitchen Hood Area Old Kitchen Storage Room	2,500 SF	Tile: ND; Mastic: 5% Chrysotile Grout: ND
29A 29B 29C	Wall Plaster	Old Kitchen Hall Old Kitchen Storage Room Old Kitchen Work Room	NA	ND
30A 30B 30C	12" Beige Floor Tile with Streaks and Brown Mastic	Plan Storage Room- West Wing Lunch Room – West Wing Men's Rest Room- West Wing	NA	ND
31A	Grey Square Pattern Linoleum	Veteran's Office Hall Entrance	NA	ND
32A	Slate Pattern Linoleum	Veteran's Office Rest Room	NA	ND
33A	12" Off White Floor Tile with Black Streaks and Mastic	APL Cell Hallway	NA	ND
34A 34B 34C	Exterior Stucco	South East Wing North East Wing West Wing	NA	ND
35A 35B 35C	Debris	Boiler Room @ Piping Boiler Room @ Boiler Boiler Room @ Boiler Rear	1,000 SF	50% Chrysotile, 20% Amosite

NA = only quantities of asbestos containing materials provided; ND = none detected; SF = Square Feet

II. LIMITATION OF BULK SAMPLING OF SUSPECT MATERIALS

Reasonable efforts have been made by ATC personnel to locate and sample suspect ACMs. However, for any facility the existence of unique or concealed ACMs and debris is a possibility. In addition, sampling and laboratory analysis constraints typically hinder the investigation. ATC does not warrant, guarantee or profess to have the ability to locate or identify all asbestos containing materials and/or lead containing paints at the site.

III. CONCLUSIONS AND RECOMMENDATIONS

ATC performed an asbestos survey at the site on May 20 and 21, and ATC performed additional sampling at the site November 5, 2009. The purpose of this survey was to identify ACMs at the site. The purpose of the additional sampling was to determine if debris located within the boiler room of the site contains asbestos. The table below provides a summary of ACMs identified at the site.

SOUTH ANNEXBUILDING 938 14 TH STREET, MARYSVILLE, CA 95901 ASBESTOS CONTAINING MATERIALS				
MATERIAL DESCRIPTION	MATERIAL LOCATION*	QUANTITY*	CONDITION*	NESHAP CATEGORY
Boiler Insulation	Boiler Room	1,000 SF	Poor	RACM
Pipe Insulation	Boiler Room	200 LF	Poor	RACM
Mudded Elbow	Boiler Room	60 EA	Poor	RACM
Tan (Yellow) Linoleum	Middle Wing Break Room	200 SF	Good	RACM
Grey/White (Tan) Pebble Pattern Vinyl Flooring	Women's Rest Room - Northeast Wing Men's Rest Room - Northeast Wing	160 SF	Good	CAT I
12" Cream Vinyl Floor Tile with Streaks and Mastic	Rest Room- Northwest Wing	160 SF	Good	CAT I
6" Red Ceramic Tile with Grout and Brown Mastic	Old Kitchen Dinning Room Area	2,500 SF	Good	CAT I
Debris	Boiler Room	1,000 SF	Poor	RACM
* Locations, quantities and conditions are based on observations of accessible materials, additional locations, quantities and conditions may exist in concealed or inaccessible areas. RACM = Regulated Asbestos Containing Material; CAT I = Category I Non-friable Asbestos Containing Material; SF = square feet				

Based on the findings of the asbestos survey performed at the site on May 20 and 21, and the additional sampling performed on November 5, 2009, ATC makes the following recommendations:

- All ACMs, RACM and CAT I, that will be impacted by the planned demolition at the site must be removed prior to disturbance by a licensed asbestos abatement contractor in accordance with all local, state and federal regulations.
- All ACM wastes must be handled and disposed of in accordance with all local, state and federal regulations.
- In order to ensure that all ACM removal and waste handling is performed in accordance with all local, state and federal regulations, ATC recommends contracting the services of a DOSH CAC to monitor and clear asbestos abatement activities.

If you have any questions regarding this report or require additional services, please do not hesitate to contact our office at (925) 460-5300.

Respectfully submitted,
 ATC Associates Inc.



Daniel Moran, CSST# 08-4417
 Staff Hygienist



Paul Lowe, CAC# 07-4137
 Project Manager

Attachments: A - Laboratory Analytical Reports
 B - Inspector Certifications and Laboratory Accreditation
 C - Sample Location Maps

ATTACHMENT A:
LABORATORY ANALYTICAL REPORTS



Hygeia Laboratories Inc.

82 W. Sierra Madre Blvd
Sierra Madre, CA 91024-2434
(626) 355-4711 (626) 355-4497 Fax

NIST/NVLAP Lab Code 102116-0
California ELAP Certificate No. 1269

Bulk Sample Analysis Summary

Analytical Method: EPA 600/R-93/116

May 26, 2009

Mr. Paul Lowe ATC Pleasanton 6602 Owens Drive, STE 100 Pleasanton, CA 94588		Hygeia Reference No.: 00075 09 0029 Samples Analyzed: 103 Sampler: D. Moran Sample Condition: Acceptable Date Collected: May 20-21, 2009 Date Received: May 22, 2009 Date Analyzed: May 26, 2009																
Client Reference: 75.38867.0001 Yuba County South Annex Building		Asbestos Type, %						Non-Asbestos Constituents, %							QC			
Client Sample ID Hygeia Sample ID	Sample Description - color Comments	Asbestos Detected	Chrysotile	Amosite	Crocidolite	Tremolite / Actinolite	Anthophyllite	Other	Cellulose	Fiberglass	Synthetic	Mineral Fillers	Vermiculite	Organic Binders		Foam	Paint	Perlite
1A 1173274	Rolled roofing - grey/black	No							30	30		40						
1B 1173275	Rolled roofing - grey/black	No							30	30		40						
1C 1173276	Rolled roofing - grey/black	No							5	25	30	40						X
2A 1173277	Roofing shingle - brown/black	No							10	20	30	40						
2B 1173278	Roofing shingle - brown/black	No							10	20	30	40						
2C 1173279	Roofing shingle - brown/black	No							10	20	30	40						
3A 1173280	Penetration mastic - black	No							20		30	50						
3B 1173281	Penetration mastic - black	No							20		30	50						
3C 1173282	Penetration mastic - black	No							20		30	50						
4A 1173283	Foam roof - silver/yellow	No							3	7	5	5	80					
4B 1173284	Foam roof - silver/yellow	No							3	7	5	5	80					
4C 1173285	Foam roof - silver/yellow	No							3	7	5	5	80					
5A 1173286	HVAC duct caulk - grey	No							5		45	50						X
5B 1173287	HVAC duct caulk - grey	No							25		30	45						
5C 1173288	HVAC duct caulk - grey	No							5		50	45						



Bulk Sample Analysis Summary

Analytical Method: EPA 600/R-93/116

May 26, 2009

Client Reference: 75.38867.0001 Yuba County South Annex Building		Asbestos Type, %						Non-Asbestos Constituents, %						QC			
		Asbestos Detected	Chrysotile	Amosite	Crocidolite	Tremolite / Actinolite	Anthophyllite	Other	Cellulose	Fiberglass	Synthetic	Mineral Fillers	Vermiculite		Organic Binders	Foam	Paint
Client Sample ID Hygeia Sample ID	Sample Description - color Comments																
6A 1173289	Caulk at flashing - white/grey	No									40	60					
6B 1173290	Caulk at flashing - white/grey	No									40	60					
6C 1173291	Caulk at flashing - white/grey	No									40	60					
7A 1173292	Boiler insulation - white	Yes	10	15							75						
8A 1173295	Pipe insulation - grey	No						20			80						
8B 1173296	Pipe insulation - grey	Yes	20					20			60						
9A 1173298	Mudded elbow - grey	Yes	90								10						
10A 1173301	Fiberboard material - tan	No						60			40						X
10B 1173302	Fiberboard material - tan	No						60			40						
10C 1173303	Fiberboard material - tan	No						60			40						
11A 1173304	Wallboard/joint compound - white	No						5			95						
11B 1173305	Wallboard/joint compound - white	No						5			95						
11C 1173306	Wallboard/joint compound - white	No						5			95						
11D 1173307	Wallboard/joint compound - white	No						5			95						
11E 1173308	Wallboard/joint compound - white	No						5			95						
11F 1173309	Wallboard/joint compound - white	No						5			95						



Bulk Sample Analysis Summary

Analytical Method: EPA 600/R-93/116

May 26, 2009

Client Reference: 75.38867.0001 Yuba County South Annex Building		Asbestos Type, %						Non-Asbestos Constituents, %						QC			
		Asbestos Detected	Chrysotile	Amosite	Crocidolite	Tremolite / Actinolite	Anthophyllite	Other	Cellulose	Fiberglass	Synthetic	Mineral Fillers	Vermiculite		Organic Binders	Foam	Paint
Client Sample ID Hygeia Sample ID	Sample Description - color Comments																
11G 1173310	Wallboard/joint compound - white	No						5			95						
12A 1173311	Wall texture - white	No									80				20		
12B 1173312	Wall texture - white	No									80				20		
12C 1173313	Wall texture - white	No									80				20		
12D 1173314	Wall texture - white	No									80				20		
12E 1173315	Wall texture - white	No									80				20		
12F 1173316	Wall texture - white	No									80				20		X
12G 1173317	Wall texture - white	No									80				20		
13A 1173318	4" covebase - grey	No									60	40					
13A 1173318M	Covebase mastic - brown	No									30	70					
14A 1173319	Linoleum flooring - tan	No						30			30	40					
15A 1173320	Linoleum flooring - yellow	Yes	30								30	40					
16A 1173321	Linoleum flooring - blue	No						30			30	40					
17A 1173322	Linoleum flooring - grey/blue	No						40			30	30					
18A 1173323	Carpet mastic - yellow	No						2		3	30	65					
18B 1173324	Carpet mastic - yellow	No						2		3	30	65					
18C 1173325	Carpet mastic - yellow	No						2		3	30	65					X
19A 1173326	4" covebase - green	No									70	30					X



Bulk Sample Analysis Summary

Analytical Method: EPA 600/R-93/116

May 26, 2009

Client Reference: 75.38867.0001 Yuba County South Annex Building		Asbestos Type, %						Non-Asbestos Constituents, %						QC			
		Asbestos Detected	Chrysotile	Amosite	Crocidolite	Tremolite / Actinolite	Anthophyllite	Other	Cellulose	Fiberglass	Synthetic	Mineral Fillers	Vermiculite		Organic Binders	Foam	Paint
Client Sample ID Hygeia Sample ID	Sample Description - color Comments																
19A 1173326M	Covebase mastic - white	No									60	40					X
19B 1173327	4" covebase - green	No									70	30					
19B 1173327M	Covebase mastic - white	No									60	40					
19C 1173328	4" covebase - green	No									70	30					
19C 1173328M	Covebase mastic - white	No									60	40					
20A 1173329	2' x 4' ceiling tile - white	No							65	15	5				5	10	
20B 1173330	2' x 4' ceiling tile - white	No							65	15	5				5	10	
20C 1173331	2' x 4' ceiling tile - white	No							65	15	5				5	10	
21A 1173332	12" x 12" floor tile - white	No									80	20					
21A 1173332M	Floor tile mastic - yellow	No									60	40					
21B 1173333	12" x 12" floor tile - grey	No									80	20					
21B 1173333M	Floor tile mastic - yellow	No									60	40					
21C 1173334	12" x 12" floor tile - grey	No									80	20					
21C 1173334M	Floor tile mastic - yellow	No									60	40					
22A 1173335	Linoleum flooring - tan	No							35	5	40	20					
22B 1173336	Linoleum flooring - tan	No							35	5	40	20					
22C 1173337	Linoleum flooring - grey	No							35	5	40	20					
23A 1173338	12" x 12" floor tile - white	No									80	20					X
23A 1173338M	Floor tile mastic - yellow	No									60	40					



Bulk Sample Analysis Summary

Analytical Method: EPA 600/R-93/116

May 26, 2009

Client Reference: 75.38867.0001 Yuba County South Annex Building		Asbestos Type, %						Non-Asbestos Constituents, %						QC			
		Asbestos Detected	Chrysotile	Amosite	Crocidolite	Tremolite / Actinolite	Anthophyllite	Other	Cellulose	Fiberglass	Synthetic	Mineral Fillers	Vermiculite		Organic Binders	Foam	Paint
Client Sample ID Hygeia Sample ID	Sample Description - color Comments																
24A 1173339	4" covebase - grey	No									80	20					
24A 1173339M	Covebase mastic - brown	No						5			25	70					
24B 1173340	4" covebase - grey	No									70	30					
24B 1173340M	Covebase mastic - white	No									60	40					
24C 1173341	4" covebase - grey	No									70	30					
24C 1173341M	Covebase mastic - white	No									60	40					
25A 1173342	Carpet mastic - yellow	No									60	40					
25B 1173343	Carpet mastic - yellow	No									60	40					
25C 1173344	Carpet mastic - yellow	No									60	40					
26A 1173345	Vinyl sheet flooring - tan	Yes	30					10			40	20					
27A 1173347	12" x 12" floor tile - white	Yes	< 1								80	20					
27A 1173347M	Floor tile mastic - yellow	No									60	40					
28A 1173348A	6" ceramic tile - red	No									100						
28A 1173348B	Mastic - brown/tan	Yes	5								30	65					
28A 1173348C	Grout - white	No						10			90						
28B 1173349A	6" ceramic tile - red	No						10			90						
28B 1173349C	Grout - white	No						10			90						
28C 1173350A	6" ceramic tile - white	No									100						
28C 1173350C	Grout - white	No						10			90						



Bulk Sample Analysis Summary

Analytical Method: EPA 600/R-93/116

May 26, 2009

Client Reference: 75.38867.0001 Yuba County South Annex Building		Asbestos Type, %						Non-Asbestos Constituents, %						QC			
		Asbestos Detected	Chrysotile	Amosite	Crocidolite	Tremolite / Actinolite	Anthrophyllite	Other	Cellulose	Fiberglass	Synthetic	Mineral Fillers	Vermiculite		Organic Binders	Foam	Paint
Client Sample ID Hygeia Sample ID	Sample Description - color Comments																
29A 1173351	Wall plaster - white	No									95				5		
29B 1173352	Wall plaster - white	No									95				5		X
29C 1173353	Wall plaster - white	No									95				5		
30A 1173354	12" x 12" floor tile - white	No									80		20				
30A 1173354M	Floor tile mastic - yellow	No									60		40				
30B 1173355	12" x 12" floor tile - white	No									80		20				
30B 1173355M	Floor tile mastic - yellow	No									60		40				
30C 1173356	12" x 12" floor tile - white	No									80		20				
30C 1173356M	Floor tile mastic - yellow	No									60		40				
31A 1173357	Linoleum flooring - grey	No							40		40		20				
32A 1173358	Linoleum flooring - tan	No							40		40		20				X
33A 1173359	12" x 12" floor tile - white	No									80		20				
33A 1173359M	Floor tile mastic - yellow	No							5		40		55				
34A 1173360	Exterior stucco - grey	No									100						
34B 1173361	Exterior stucco - grey/tan	No									100						
34C 1173362	Exterior stucco - grey/tan	No									100						

Microscopist - Fidel Gutierrez

Microscopist - Guillermo Hernandez

The analyses of the samples in this report were performed using polarized light microscopy using the EPA method 600/R-93/116. The phase abundances provided are visually estimated and expressed as percent area. Total percentage of sample constituents may total greater than 100 due to trace amounts. The limit of detection for this analytical method is less than one percent. In multilayer samples, unless otherwise specified, the asbestos concentration is reported for the layer where asbestos is found. These results lie within the statistical limits of variability calculated for standard reference samples routinely analyzed in the laboratory. On a per sample basis, the accuracy and precision of the results depend on the type of sample and its asbestos content.



Bulk Sample Analysis Summary

Analytical Method: EPA 600/R-93/116

May 26, 2009

Hygeia recommends transmission electron microscopy (TEM) analysis on organically bound bulk materials (eg., vinyl floor tile, mastics, roofing materials, joint compounds) when PLM analysis shows undetectable quantities of asbestos. These materials often contain milled asbestos with fiber diameters and lengths too small to be resolved by the PLM and the analysis may yield a false negative result.

Hygeia Laboratories Inc. is accredited under the NIST/NVLAP program for asbestos in bulk material by polarized light microscopy and the State of California for asbestos analysis.

Hygeia Laboratories Inc. and its personnel shall not be liable for any misinformation provided to us by the client regarding these samples or for any misuse or interpretation of information supplied by us. Liability shall extend to providing replicate analyses only. This report must not be used to claim product endorsement by NVLAP or any agency of the US Government. Hygeia will retain samples for a period of three months unless otherwise specified. This report relates only to samples submitted and analyzed. This report may not be reproduced except for in full, without the written approval of this laboratory. Please feel free to contact Hygeia regarding any questions about these results, this report, or the analytical methods employed.

Arturo Casas - Supervisor of Optical Microscopy

ATC Request for Laboratory Services / Chain of Custody - Asbestos

Send Report To PAUL LOWE

Company Name ATC Pleasanton

Company Address 6602 Owens Drive, STE 100

Company Address Pleasanton, CA 94588

Phone (925) 460-5300 Fax (925) 463-2559

Client Project No 75-38867.0001

Client Project Ref Yuba County South Annex Building

Bill Branch No. 75 (For Inter-Company billing purposes, please provide correct Project and Task No.)

Samples Submitted 89 Samples Analyzed 103 Hygeia Reference No 00075 09 0029

Hygeia Laboratories Inc.
82 W. Sierra Madre Blvd.
Sierra Madre, CA 91024
(626) 355-4711
(626) 355-4497 FAX



Reporting Fax Cell/Pager _____

Phone _____ E-mail Paul.Lowe@ATCAssociates.com

Turnaround Time _____ Normal (3-5 business days) Next Day (24 hrs) _____ Same Day (Rush) _____ Weekend Rush _____

Type of Sample _____ Air Bulk _____ Dust (microvac) _____ Dust (wipe) _____ Soil _____ Paint _____ Water _____ Other _____

Asbestos (Optical) <input checked="" type="checkbox"/> PLM _____ PLM Point Count 400 pts _____ PLM Point Count 1000 pts _____ PCM	Asbestos (TEM) _____ AHERA _____ EPA Level II _____ NIOSH 7402 (PCM Equivalent) _____ ISO 10312	_____ Qualitative Dust (microvac or wipe) _____ Quantitative Dust (microvac or wipe) _____ Drinking Water (potable) _____ Wastewater (non-potable)	_____ Qualitative Bulk _____ Semi-Quantitative Bulk _____ Full-Quantitative Bulk _____ Particle Characterization _____ Supplies
--	--	---	---

Additional Instructions STOP @ 1st positive per H.A.

For Lab Use Only Sample Integrity accept _____ reject _____ 1st Sample No 1173274-362

Results reported by: _____ Price / Sample _____

Date _____ Time _____ Initials _____ Verbal Fax E-mail _____

Date _____ Time _____ Initials _____ Verbal Fax E-mail _____ Invoice No. 77-

Date _____ Time _____ Initials _____ Verbal Fax E-mail _____ Log Out Date _____

Comments
COLLECTED COLLECTION DATES PROVIDED BY PAUL LOWE, 5/26/09.
SECOND #117 WAS COLLECTED TO #116 PER PAUL'S INSTRUCTION.

Relinquished By (Signature)	Received By (Signature)	Time	Date	Reason for Change of Custody
<u>[Signature]</u>	<u>[Signature]</u>	<u>16:00</u>	<u>5-23-09</u>	<u>Analyze</u>
<u>Fed Ex</u>	<u>[Signature]</u>	<u>9:33 AM</u>	<u>5/22/09</u>	

The sample collector is responsible for ensuring that all samples have been preserved according to the appropriate and applicable methodology.

00075 09 0029

PLM - CHAIN OF CUSTODY - BULK SAMPLE LOG

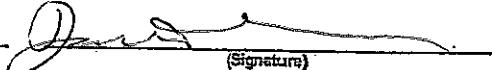
Project Name: YUBA COUNTY SOUTH ANNEX BUILDING Project Number: 75.38867.0001
 Project Location: 938 14th STREET, MARYSVILLE, CA Sample Date: 5-20-09
~~5-22-09~~
 Turn-Around Time/Due Date: 24 HOUR TURN
 Special Instructions: STOP @ 15⁺ positive per H.A.
 Samples Collected by: Daniel MORAN 
(Print Name) (Signature)

SAMPLE NUMBER	LAB ID	MATERIAL DESCRIPTION	SAMPLE LOCATION
1A		GREY ROLL ROOFING w/BLACK TAR	ROOF OVER BOILER ROOM
1B		↓	EASTERN ROOF
1C		↓	NORTHWEST ROOM
2A		BROWN ROOF SHINGLE w/BLACK TAR PAPER	FAR EAST ROOF
2B		↓	ROOF OVER KITCHEN
2C		↓	SOUTH WEST ROOF
3A		BLACK PENETRATION MASTIC	WEST CENTRAL ROOF
3B		↓	SOUTH WEST CENTRAL ROOF
3C		↓	EAST CENTRAL ROOF
4A		SILVER FOAM ROOF	ROOF OVER BOILER RM SOUTH CENTRAL
4B		↓	" " EAST
4C		↓	" " NORTHWEST
5A		GREY HVAC DUCT CAULK	SOUTH CENTRAL ROOF
5B		↓	CENTRAL ROOF
5C		↓	WEST ROOF
6A		GREY CAULK @ FLASHINGS	SOUTH CENTRAL ROOF
6B		↓	EAST ROOF
6C		↓	NORTHWEST ROOF

Relinquished by:

Received by:

Date/Time:

(Print)

(Print)

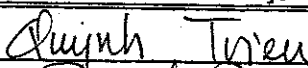

5/22/09

(Signature)

(Signature)



9:33 AM

(Print)

(Print)

(Signature)

(Signature)

00075 09 0029

PLM - CHAIN OF CUSTODY - BULK SAMPLE LOG

Project Name: YUBA COUNTY SOUTH Annex Building Project Number: 75.38867.0001
 Project Location: 938 14th STREET, MARYSVILLE, CA Sample Date: 5-20-09
5-22-09
 Turn-Around Time/Due Date: 24 Hour Turn
 Special Instructions: STOP @ 1st Positive per HA
 Samples Collected by: Daniel Moran 
(Print Name) (Signature)

SAMPLE NUMBER	LAB ID	MATERIAL DESCRIPTION	SAMPLE LOCATION
7A		Boiler Insulation	LARGE BOILER
7B		↓	DOUBLE BOILER (RIGHT)
7C			DOUBLE BOILER (LEFT)
8A			SMALL BOILER (BETWEEN LRG)
8B		↓	DOUBLE BOILER (RIGHT)
8C			DOUBLE BOILER (LEFT)
9A			MUDDIED ELBOW
9B		↓	DOUBLE BOILER RIGHT ELBOW
9C			DOUBLE BOILER LEFT ELBOW
10A			BROWN FIBERBOARD MATERIAL
10B		↓	BOILER ROOM SIDE CEILING
10C			BOILER ROOM (NEAR RR)
11A			WALL BOARD / JOINT COMPOUND
11B		↓	WEST WING CLOSET
11C			SOUTH EAST OFFICE - MIDDLE WING
11D			NORTH CLOSET - EAST WING
11E			RESTROOM HALLWAY - EAST WING
11F			RESTROOM - NORTH WEST WING
11G			HALLWAY - SOUTH WEST WING

Relinquished by:		Received by:		Date/Time:
(Print)		(Print)	Quynh Trieu	5/22/09
(Signature)		(Signature)		9:33 AM
(Print)		(Print)		
(Signature)		(Signature)		

00075 09 0029

PLM - CHAIN OF CUSTODY - BULK SAMPLE LOG

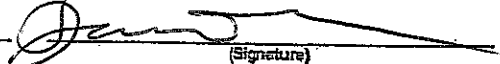
Project Name: YUBA COUNTY SOUTH ANNEX BUILDING Project Number: 75.39867.0001
 Project Location: 938 14th STREET, MARRYSVILLE, CA Sample Date: 5-20-09
 Turn-Around Time/Due Date: 24 Hour
 Special Instructions: STOP @ 1st Positive per HA.
 Samples Collected by: Daniel MURAN (Print Name)  (Signature)

SAMPLE NUMBER	LAB ID	MATERIAL DESCRIPTION	SAMPLE LOCATION
12A		WALL TEXTURE	SHOP ROOM STAIRWAY
12B			WEST WING CLOSET
12C			SOUTHEAST OFFICE - MIDDLE WING
12D			NORTH CLOSET - EAST WING
12E			RESTROOM HALLWAY - EAST WING
12F			REST ROOM - NORTH WEST WING
12G			HALLWAY - SOUTH WEST WING
13A		4" TAN COVERBASE w/ BROWN MASTIC	BREAK ROOM - MIDDLE WING
14A		CREAM SQUARE PATTERN LINOLEUM	BREAK ROOM - MIDDLE WING
15A		TAN LINOLEUM	BREAK ROOM - MIDDLE WING
16A		LIGHT BLUE SPECKLED LINOLEUM	REST ROOM - MIDDLE WING
17A		GRAY-BIVE SQUARE PATTERN LINOLEUM	HALLWAY RESTROOM - MIDDLE WING
18A		TAN CARPET MASTIC <small>under GREEN CARPET</small>	OFFICE A - MIDDLE WING
18B		↓	OFFICE B - MIDDLE WING
18C			OFFICE C - MIDDLE WING
19A			4" DARK GREEN COVERBASE w/ white MASTIC
19B		↓	OFFICE B - MIDDLE WING
19C			OFFICE C MIDDLE WING

Relinquished by:

Received by:

Date/Time:

(Print)

(Print)

Quynh Tran

5/22/09

(Signature)

(Signature)

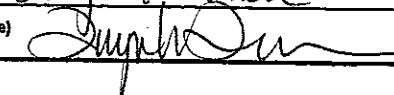

9:33 AM

(Print)

(Print)

(Signature)

(Signature)

08075 09 0029

PLM - CHAIN OF CUSTODY - BULK SAMPLE LOG

Project Name: YUBA COUNTY SOUTH ANNEX BUILDING Project Number: 75-38867-0001
 Project Location: 938 14th STREET, MARRYSVILLE, CA Sample Date: 5-20-09
5-22-09
 Turn-Around Time/Due Date: 24 Hour Turn
 Special Instructions: Stop @ 1st Positive per H.A.
 Samples Collected by: D. MORAN (Print Name) (Signature)

SAMPLE NUMBER	LAB ID	MATERIAL DESCRIPTION	SAMPLE LOCATION
20A		WHITE 2x4 FISSURE PATTERN ^{CEILING} TILES	HALLWAY - EAST WING
20B		↓	BREAK ROOM - EAST WING
20C			OFFICE C - EAST WING
21A		12" LIGHT GREEN SPECKLED FLOOR TILE w/ MASTIC	ENTRY HALL - EAST WING
21B		↓	BREAK ROOM - EAST WING
21C			REST ROOM HALL - EAST WING
22A		GREY PEBBLE PATTERN Linoleum	Womens RR - EAST WING
22B		↓	MENS RR - SOUTH EAST WING
22C			Womens RR - SOUTH EAST WING
23A		12" WHITE SPECKLED FLOOR TILE w/ MASTIC	RESTROOM - NORTHEAST WING
24A		4" GREY COVEBASE w/ MASTIC	REST ROOM - NORTH EAST WING
24B		↓	HALL - NORTH EAST WING
24C			Entry - NORTH EAST WING
25A		YELLOW CARPET MASTIC ^{UNDER PINK} CARPET	WEST OFFICE - EAST WING
25B		↓	NORTH CLOSET - EAST WING
25C			NORTH OFFICE - EAST WING
26A		GREY-WHITE PEBBLE PATTERN ^{VINYL} FLOORING	WOMENS RR - NORTH WEST WING
26B		↓	MENS RR - NORTH WEST WING
27A		12" CREAM VET w/ STREAKS and MASTIC	NORTH WEST WING - RR

Relinquished by:		Received by:		Date/Time:
(Print)		(Print)	<u>Duyuh Tieu</u>	<u>5/22/09</u>
(Signature)		(Signature)		<u>9:33 AM</u>
(Print)		(Print)		
(Signature)		(Signature)		

00075 09 0029

PLM - CHAIN OF CUSTODY - BULK SAMPLE LOG

Project Name: YOBA COUNTY SOUTH Annex Building Project Number: 75-38867:0001
 Project Location: 938 14th STREET, MARYSVILLE, CA Sample Date: 5-21-09
5-23-09
 Turn-Around Time/Due Date: 24 Hour turn
 Special Instructions: STOP @ 1st Positive per H.A.
 Samples Collected by: D. MORAN (Print Name) (Signature)

SAMPLE NUMBER	LAB ID	MATERIAL DESCRIPTION	SAMPLE LOCATION
28A		6" RED CERAMIC TILE ^{w GROUT and} _{BROWN MASTIC}	OLD KITCHEN WORK ROOM
28B		↓	OLD KITCHEN HOOD AREA
28C		↓	OLD KITCHEN STORAGE RM.
29A		WALL PLASTER	OLD KITCHEN HALL
29B		↓	OLD KITCHEN STORAGE
29C		↓	OLD KITCHEN WORK RM.
30A		12" BEIGE TILE "STREAKS" / BROWN MASTIC	PLAN STORAGE ROOM (WESTWING)
30B		↓	LUNCH ROOM (WESTWING)
30C		↓	MENS RR. (WESTWING)
31A	180 SF	GREY SQUARE PATTERN Linoleum	VETERENS OFFICE HALL ENTRANCE
32A	150 SF	SLATE PATTERN Linoleum	VETERENS OFFICE RR.
33A	150 SF	12" OFF WHITE FLOOR TILE "BLK STREAKS" ^{and} _{MASTIC}	APL CELL HALLWAY
34A		EXTERIOR STUCCO	SOUTH EASTWING
34B		↓	NORTH EASTWING
34C		↓	WESTWING

Relinquished by:		Received by:		Date/Time:
(Print)		(Print)	Daphn Trien	5/22/09
(Signature)		(Signature)		9:33 AM
(Print)		(Print)		
(Signature)		(Signature)		



Hygeia Laboratories Inc.

82 W. Sierra Madre Blvd
Sierra Madre, CA 91024-2434
(626) 355-4711 (626) 355-4497 Fax

NIST/NVLAP Lab Code 102116-0
California ELAP Certificate No. 1269

Bulk Sample Analysis Summary

Analytical Method: EPA 600/R-93/116

November 9, 2009

Mr. Paul Lowe ATC Pleasanton 6602 Owens Drive, STE 100 Pleasanton, CA 94588		<p style="text-align: right;"><u>Hygeia Reference No.:</u> 00075 09 0077</p> <p>Samples Analyzed: 3 Sampler: P. Lowe Sample Condition: Acceptable</p> <p>Date Collected: November 5, 2009 Date Received: November 6, 2009 Date Analyzed: November 9, 2009</p>												
<p>Client Reference: 75.38867.0001 Yuba County South Annex - Marysville</p>		Asbestos Type, %					Non-Asbestos Constituents, %					QC		
		Asbestos Detected	Chrysotile	Amosite	Crocidolite	Tremolite / Actinolite	Anthophyllite	Other	Cellulose	Fiberglass	Synthetic		Mineral Fillers	Vermiculite
Client Sample ID Hygeia Sample ID	Sample Description - color <i>Comments</i>													
35A 1192535	Boiler room debris - grey	Yes	50					40			10			
35B 1192536	Boiler room debris - white	Yes	5	20							75			
35C 1192537	Boiler room debris - white	Yes	5					10			85			X

Microscopist - Fidel Gutierrez

The analyses of the samples in this report were performed using polarized light microscopy using the EPA method 600/R-93/116. The phase abundances provided are visually estimated and expressed as percent area. Total percentage of sample constituents may total greater than 100 due to trace amounts. The limit of detection for this analytical method is less than one percent. In multilayer samples, unless otherwise specified, the asbestos concentration is reported for the layer where asbestos is found. These results lie within the statistical limits of variability calculated for standard reference samples routinely analyzed in the laboratory. On a per sample basis, the accuracy and precision of the results depend on the type of sample and its asbestos content.

Hygeia recommends transmission electron microscopy (TEM) analysis on organically bound bulk materials (eg., vinyl floor tile, mastics, roofing materials, joint compounds) when PLM analysis shows undetectable quantities of asbestos. These materials often contain milled asbestos with fiber diameters and lengths too small to be resolved by the PLM and the analysis may yield a false negative result.

Hygeia Laboratories Inc. is accredited under the NIST/NVLAP program for asbestos in bulk material by polarized light microscopy and the State of California for asbestos analysis.

Hygeia Laboratories Inc. and its personnel shall not be liable for any misinformation provided to us by the client regarding these samples or for any misuse or interpretation of information supplied by us. Liability shall extend to providing replicate analyses only. This report must not be used to claim product endorsement by NVLAP or any agency of the US Government. Hygeia will retain samples for a period of three months unless otherwise specified. This report relates only to samples submitted and analyzed. This report may not be reproduced except for in full, without the written approval of this laboratory. Please feel free to contact Hygeia regarding any questions about these results, this report, or the analytical methods employed.

Arturo Casas - Supervisor of Optical Microscopy

ATC Request for Laboratory Services / Chain of Custody - Asbestos

Send Report To PAUL LOWE

Company Name ATC Pleasanton

Company Address 6602 Owens Drive, STE 100

Company Address Pleasanton, CA 94588

Phone (925) 460-5300 Fax (925) 463-2559

Client Project No 75.38867.0001

Client Project Ref YUBA COUNTY SOUTH ANNEX

Bill Branch No. 75 (For Inter-Company billing purposes, please provide correct Project and Task No.)

Samples Submitted 3 Samples Analyzed _____ Hygeia Reference No 00075 09 0077

Hygeia Laboratories Inc.
82 W. Sierra Madre Blvd.
Sierra Madre, CA 91024
(626) 355-4711
(626) 355-4497 FAX

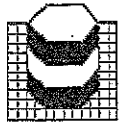

Reporting Fax Cell/Pager _____
Phone _____ E-mail

Turnaround Time _____ Normal (3-5 business days) Next Day (24 hrs) _____ Same Day (Rush) _____ Weekend Rush

Type of Sample _____ Air Bulk _____ Dust (microvac) _____ Dust (wipe) _____ Soil _____ Paint _____ Water _____ Other

Asbestos (Optical) <input checked="" type="checkbox"/> PLM _____ PLM Point Count 400 pts _____ PLM Point Count 1000 pts _____ PCM	Asbestos (TEM)	
	_____ AHERA	_____ Qualitative Dust (microvac or wipe)
	_____ EPA Level II	_____ Quantitative Dust (microvac or wipe)
	_____ NIOSH 7402 (PCM Equivalent)	_____ Drinking Water (potable)
	_____ ISO 10312	_____ Wastewater (non-potable)
	_____ Qualitative Bulk	_____ Semi-Quantitative Bulk
	_____ Full-Quantitative Bulk	_____ Particle Characterization
		_____ Supplies

Additional Instructions

For Lab Use Only Sample Integrity accept _____ reject

Results reported by: _____ 1st Sample No. 1192535-537
Price / Sample 8-

Date _____ Time _____ Initials _____ Verbal Fax E-mail
Date _____ Time _____ Initials _____ Verbal Fax E-mail Invoice No. 77-
Date _____ Time _____ Initials _____ Verbal Fax E-mail Log Out Date _____

Comments

Relinquished By (Signature)	Received By (Signature)	Time	Date	Reason for Change of Custody
		11:40 AM	11.6.09	
FEDEX				

The sample collector is responsible for ensuring that all samples have been preserved according to the appropriate and applicable methodology.

ATTACHMENT B:
INSPECTOR CERTIFICATIONS AND
LABORATORY ACCREDITATION

DEPARTMENT OF INDUSTRIAL RELATIONS

**DIVISION OF OCCUPATIONAL SAFETY AND HEALTH
ASBESTOS CONSULTANT and TRAINER APPROVAL UNIT**

2211 Park Towne Circle, Suite 1

Sacramento, CA 95825

Tel: (916) 574-2993 Fax: (916) 483-0572



808084417T

317

321

December 23, 2008

Daniel Moran
94 N. White Road
San Jose

CA 95127

Dear Certified Asbestos Consultant or Technician:

Congratulations, you have passed your certification examination!

Enclosed is your certification card. **To maintain your certification, please abide by the rules printed on the back of the certification card.**

Your certification is valid for a period of one year. If you wish to renew your certification, you must apply for renewal at least 60 days before the expiration date shown on your card. [8 CCR 341.15(h)(1)].

Please hold and do not send copies of your required AHERA refresher renewal certificates to the Division until you apply for renewal of your certification.

Please inform the our office at the above address or fax number of any changes in your mailing address or work address within 15 days of the change.

Sincerely,

Jeff Ferrell
Senior Industrial Hygienist

JF/ms

Attachment

cc: File

(Passed Exam - Card Attached - Revised 10/13/05)

State of California
Division of Occupational Safety and Health
Certified Site Surveillance Technician

Daniel Moran

Name

Certification No. 08-4417Expires on 12/18/09

This certification was issued by the Division of Occupational Safety and Health as authorized by Sections 7180 et seq. of the Business and Professions Code.



Environmental, Geotechnical and Materials Engineers

6602 Owens Drive, Suite 100
Pleasanton, CA 94588
www.atcassociates.com
925-460-5300
Fax 925-463-2559

State of California
Division of Occupational Safety and Health
Certified Asbestos Consultant

Paul A Lowe
Name



Certification No. **07-4137**

Expires on **02/22/10**

This certification was issued by the Division of Occupational Safety and Health as authorized by Sections 7180 et seq. of the Business and Professions Code.



**National Voluntary
Laboratory Accreditation Program**



SCOPE OF ACCREDITATION TO ISO/IEC 17025:2005

Hygeia Laboratories Inc.
 82 W. Sierra Madre Blvd.
 Sierra Madre, CA 91024-2434
 Mr. Arturo Casas
 Phone: 626-355-4711 Fax: 626-355-4497
 E-Mail: casas77@atc-enviro.com
 URL: <http://www.hygeialaboratories.com>

BULK ASBESTOS FIBER ANALYSIS (PLM)

NVLAP LAB CODE 102116-0

NVLAP Code Designation / Description

18/A01 EPA-600/M4-82-020: Interim Method for the Determination of Asbestos in Bulk Insulation Samples

2008-07-01 through 2009-06-30

Effective dates

Sally S. Bruce

For the National Institute of Standards and Technology

United States Department of Commerce
National Institute of Standards and Technology

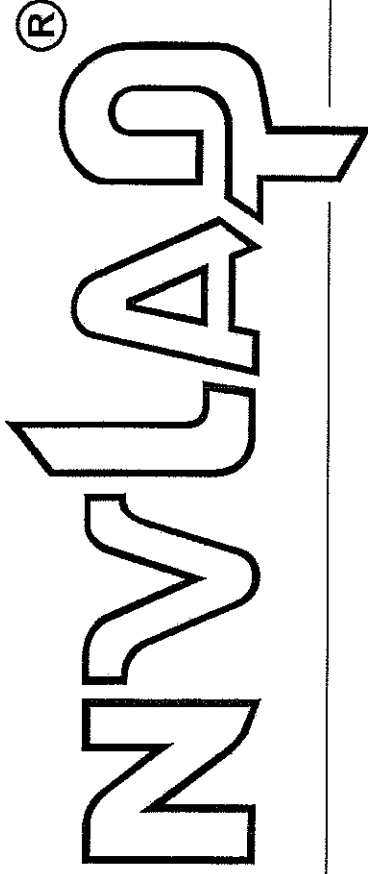

Certificate of Accreditation to ISO/IEC 17025:2005

NVLAP LAB CODE: 102116-0

Hygeia Laboratories Inc.
Sierra Madre, CA

is accredited by the National Voluntary Laboratory Accreditation Program for specific services,
listed on the Scope of Accreditation, for:

BULK ASBESTOS FIBER ANALYSIS

*This laboratory is accredited in accordance with the recognized International Standard ISO/IEC 17025:2005.
This accreditation demonstrates technical competence for a defined scope and the operation of a laboratory quality
management system (refer to joint ISO-ILAC-IAF Communiqué dated 18 June 2005).*

2008-07-01 through 2009-06-30

Effective dates



Dolly S. Bruce
For the National Institute of Standards and Technology



**National Voluntary
Laboratory Accreditation Program**



SCOPE OF ACCREDITATION TO ISO/IEC 17025:2005

Hygeia Laboratories Inc.
 82 W. Sierra Madre Blvd.
 Sierra Madre, CA 91024-2434
 Mr. Arturo Casas
 Phone: 626-355-4711 Fax: 626-355-4497
 E-Mail: casas77@atc-enviro.com
 URL: <http://www.hygeialaboratories.com>

AIRBORNE ASBESTOS FIBER ANALYSIS (TEM)

NVLAP LAB CODE 102116-0

NVLAP Code Designation / Description

18/A02 U.S. EPA's "Interim Transmission Electron Microscopy Analytical Methods-Mandatory and Nonmandatory-and Mandatory Section to Determine Completion of Response Actions" as found in 40 CFR, Part 763, Subpart E, Appendix A.

2008-07-01 through 2009-06-30

Effective dates

Sally S. Bruce
 For the National Institute of Standards and Technology

ATTACHMENT C:
SAMPLE LOCATION MAPS

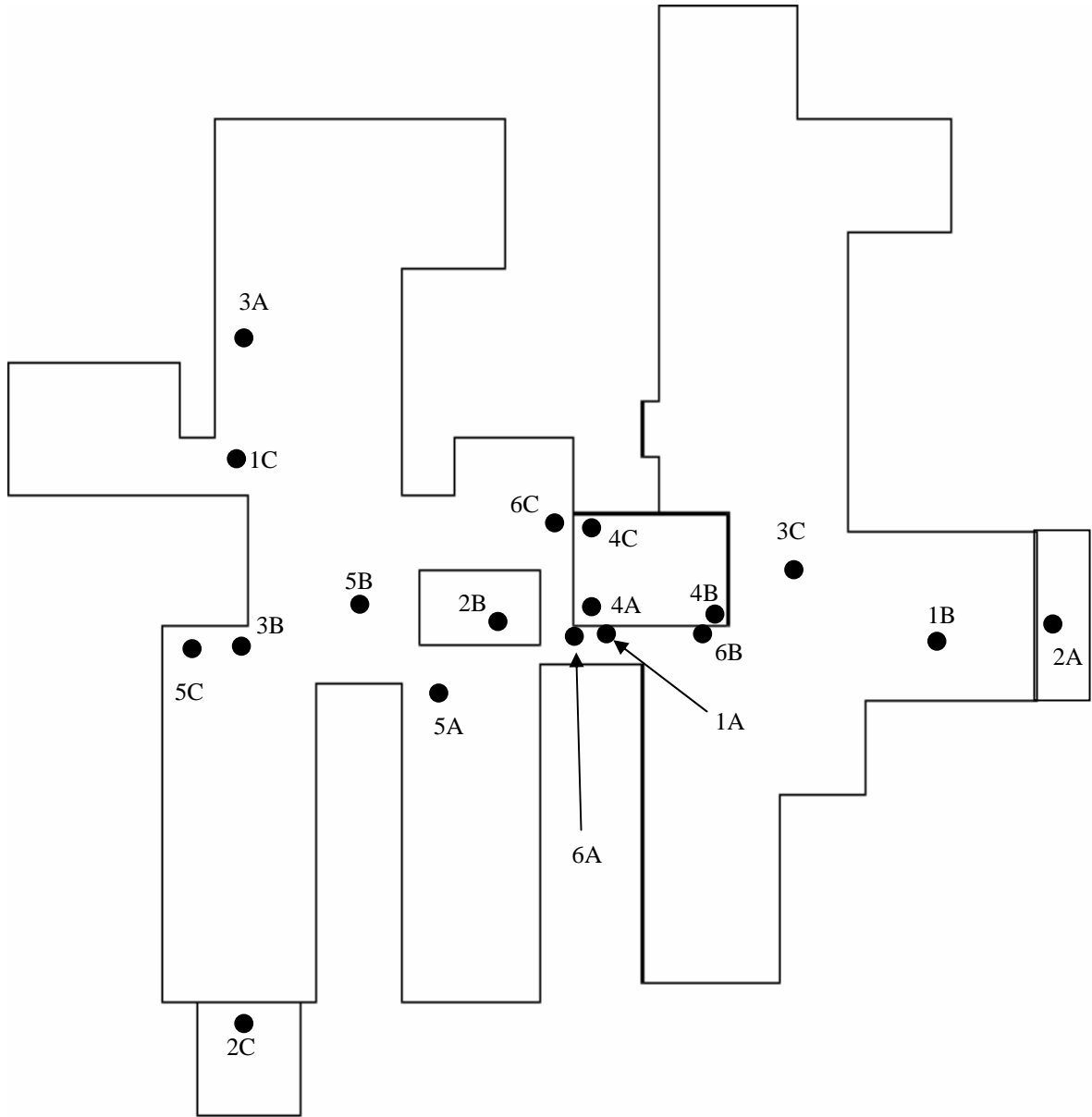

Legend

- Negative Sample Location
- Positive Sample Location



ATC Associates, Inc.
 6602 Owens Drive
 Suite 100
 Pleasanton, CA 94588

Updated Sample Location Map

SOUTH ANNEX BUILDING
 938 14th Street. Marrysville, CA, 95901

PROJECT NO: 75.38867.0001

DESIGNED BY: DM

SCALE: N/A

REVIEWED BY:

DRAWN BY: DM

DATE: 11/9/09

FILE: